

# SUBSEA DOCKING PROBE

HYDRAULIC DOCKING PROBE

Ø86



## Description

**The Docking Probe is a robust interface device designed for secure docking of ROVs and ROV/RIT-deployed tools to subsea structures.**

The unit is hydraulically actuated, providing controlled engagement and release during operations. It incorporates an integrated failsafe mechanism that automatically disengages in the event of hydraulic or power loss, ensuring safe recovery and preventing unintentional lock-in.

The design supports reliable, repeatable docking in demanding subsea environments. Can be modified to fit customer requirements.

## Typical Operations

- Docking Operations
- Tooling Operations
- Inspection
- Intervention
- Installation / retrieval

## Features

- Hydraulic actuation
- Failsafe release
- ROV/RIT compatible
- Secure Engagement
- Repeatable operation

□ The specification details are illustrative for marketing purpose only. Actual equipment may be different as a result of product improvement or other reasons. Specific interface and performance information should be reconfirmed at time of order placement. Envirent AS, Robotvegen 16, 4340 Bryne, +47 477 77 500, sales@envirent.no

# SPECIFICATIONS

## SUBSEA DOCKING PROBE

### General Technical Specifications

Type	Subsea Docking Probe Ø86
Part Number	ISO-DP
Dimensions L x W x H	341 mm x Ø160 mm x 147 mm
Weight in air / submerged	10,2 kg / 8,4 kg
Depth Rating	Full Ocean Depth
Material	440C, OM7, POM

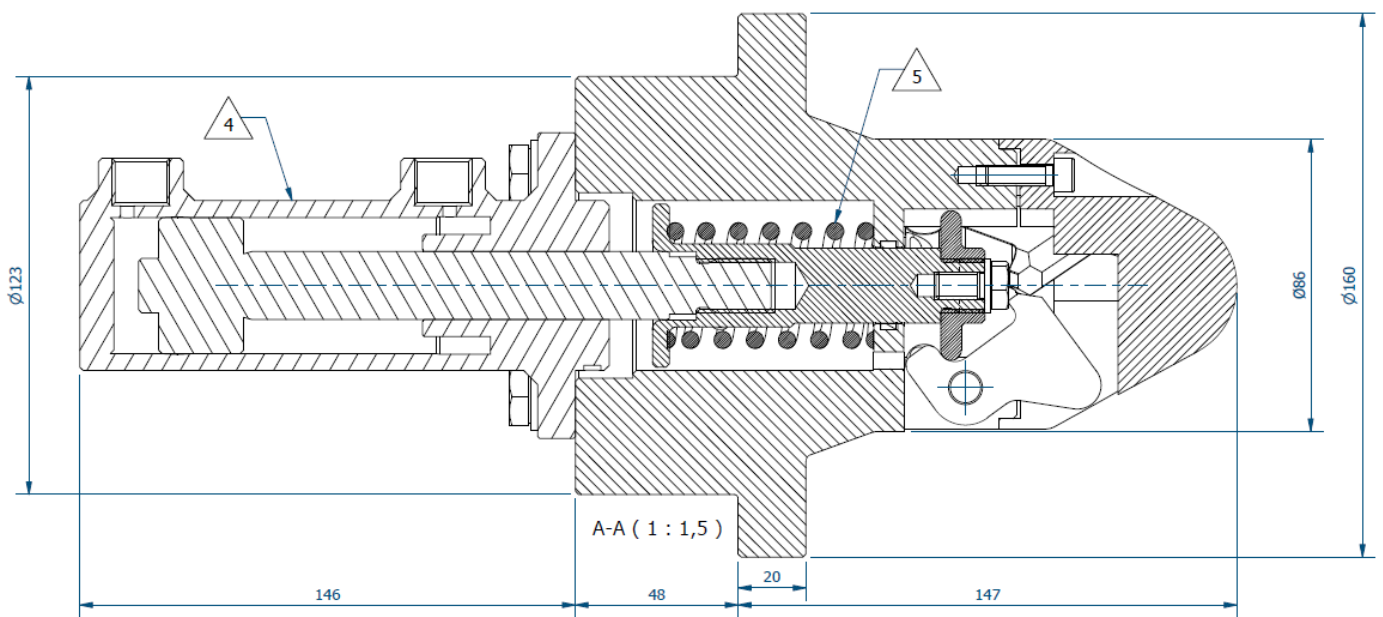

■ The specification details are illustrative for marketing purpose only. Actual equipment may be different as a result of product improvement or other reasons. Specific interface and performance information should be reconfirmed at time of order placement. Envirent AS, Robotvegen 16, 4340 Bryne, +47 477 77 500, sales@envirent.no